

MIG/MAG WELDING

TPLUS 15

trafimet
distribution

trafimet
welding & cutting



3 - 5 m
10' - 16,4'

0.6 Kg
1,43 lb

1 m
3,3'

V
peak

113



0.6 - 1.0 mm
.023" - .045"



180A CO₂
150A Mix

CODE	↔	☑
MA3033	3 m / 10'	EURO
MA3034	4 m / 12'	EURO
MA3035	5 m / 16,4'	EURO

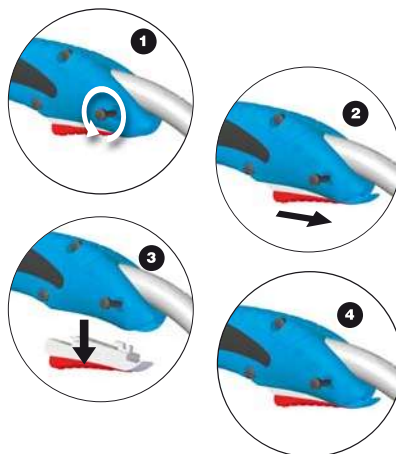

- EN Quick Trigger Replacement
- FR Remplacement rapide de la gâchette
- ES Sustitución rápida del botón
- PT Substituição rápida do botão



EN 60974-7



Ø mm	Ø in	Cu	Cu-Ni	Cu for Al	CuCrZr
0,6	.023	MD0008-06 (140.0008)	MD0008-36		
0,8	.030	MD0008-08 (140.0059)	MD0008-38	MD0008-58 (141.0002)	MD0008-78 (140.0062)
0,9	.035	MD0008-09 (140.0177)			
1,0	.040	MD0008-10 (140.0253)	MD0008-40	MD0008-60 (141.0007)	MD0008-80 (140.0256)
1,2	.045	MD0008-12 (140.0387)	MD0008-42	MD0008-62	MD0008-82



MC0017 (145.0123)	MC0018 (145.0075)	MC0266 (145.0143)	MC0019 (145.0041)	MC0020 (145.0168)
----------------------	------------------------------	----------------------	----------------------	----------------------

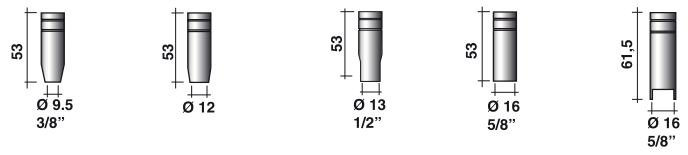

FB0117
(002.0078)
brass

EA0303
(002.0058)

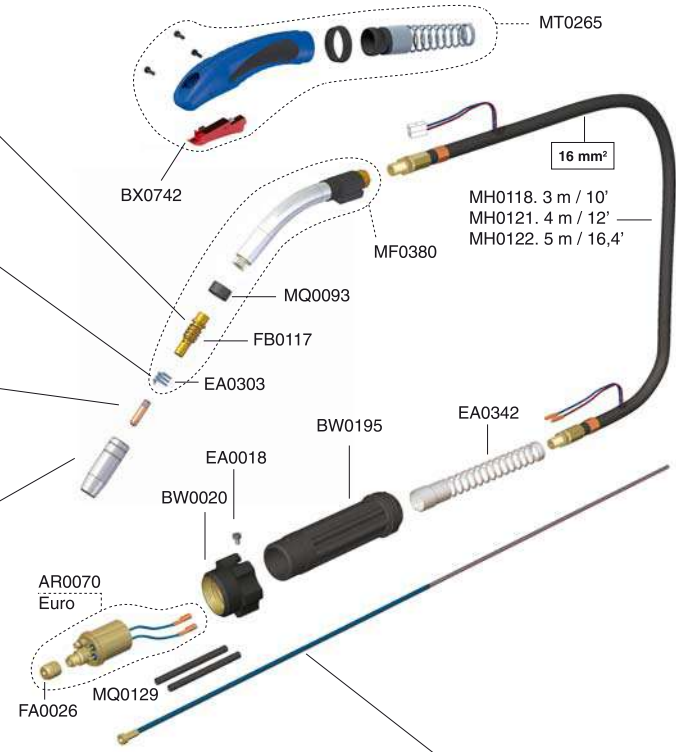

Wire	blue color	
		Steel
0,6 ± 0,9 .023 ± .035"	3 m / 10'	GM0500 (124.0011)
	4 m / 12'	GM0501 (124.0012)
	5 m / 16,4'	GM0502 (124.0015)

STANDARD (REF)