

# PT-20AMX / PT-21AMX

## Plasmarc mechanized cutting torches



- 180° In-line mechanical torch
- Excellent cutting capability
- Extremely versatile—excellent for thinner materials
- Equipped with patented safety interlock feature
- Pilot arc starting—even starts on paint
- Available with 50 ft. (15.2 m), 25 ft. (7.6 m), \*4 ft. (1.2 m) and \*17 ft. (5.2 m) torch leads
- Compatible with a variety of ESAB consoles
- Drops easily into standard 1 in. (34.9 mm) torch holders

\*4 ft. (1.2 m) and 17 ft. (5.2 m) torch leads used on Remote Arc Starter only



### Consoles

The PT-20AMX / PT-21AMX can be used with the following consoles:

- PT-20AMX
- PCM-875
- PCM-1125 (with adaptor 19500)
- PowerCut 1250
- PowerCut 1500
- ESP-100 (no adaptor)

### Specifications

| PT-20AMX / PT-21AMX      |  |
|--------------------------|--|
| Current Capacity         | 100 A @ 100% Duty Cycle  |
| Plasma Cutting           |  |
| Gas Requirements         | 350 cfm @ 85 psig  |
| Cooling Gas Requirements | 350 cfm @ 85 psig  |
| Length of Service Leads  | 4 ft. (1.2 m)<br>17 ft. (5.2 m)<br>25 ft. (7.6 m)<br>50 ft. (15.2 m) |
| Dimensions               |  |
| Length                   | 17.5 in. (444 mm)  |
| Barrel Diameter          | 1 3/8 in. (34.9 mm)  |

In conjunction with an ESAB console, the PT-20AMX torch offers the ideal solution for low cost, high performance cutting.

### Ordering Information

#### PT-20AMX - Console Connections

|   |            |
|---|------------|
| Torch with rack, 25 ft. (7.6 m) .....     | 0558003427 |
| Torch with rack, 50 ft. (15.2 m) .....    | 0558003421 |
| Torch without rack, 25 ft. (7.6 m) .....  | 0558003426 |
| Torch without rack, 50 ft. (15.2 m) ..... | 0558003422 |

#### PT-20AMX Remote Arc Starter

|  |            |
|--|------------|
| Torch without rack, 4 ft. (1.2 m) .....  | 0558003424 |
| Torch without rack, 17 ft. (5.2 m) ..... | 0558003425 |

#### PT-21AMX - PowerCut 1250 & 1500

|  |            |
|--|------------|
| Torch with rack, 25 ft. (7.6 m) .....    | 0558003616 |
| Torch with rack, 50 ft. (15.2 m) .....   | 0558003614 |
| Torch without rack, 25ft. (7.6 m) .....  | 0558003617 |
| Torch without rack 50 ft. (15.2 m) ..... | 0558003615 |

### Optional Accessories

|   |            |
|---|------------|
| Torch Holder Assembly .....                           | 16V83      |
| <b>Spare Parts Kit</b>                                |            |
| 50 A .....  | 21370      |
| 70 A .....  | 21369      |
| 90 A .....  | 0558004271 |
| 100 A .....   | 21376      |
| Plasma Flow Measuring Kit .....                       | 0558000739 |
| <b>Remote Hand Control Switch 25 ft. (7.6 m) lead</b> |            |
| PT-20AMX .....  | 680982     |
| PT-21AMX .....  | 0558003612 |
| Adaptor for PCM-875 and PCM-1125 .....                | 19500      |

# PT-20AMX / PT-21AMX

## Plasmarc mechanized cutting torches



| Heat Shield | Part Number |
|-------------|-------------|
| 30 - 50 A   | 21447       |
| 70 - 100 A  | 21326       |

| Cutting Nozzle | Part Number | Orifice Size |
|----------------|-------------|--------------|
| 30 A           | 37329       | .032         |
| 50 A           | 21330       | .042         |
| 70 A           | 21329       | .052         |
| 90 A           | 0558004269  | .056         |
| 100 A          | 21328       | .059         |

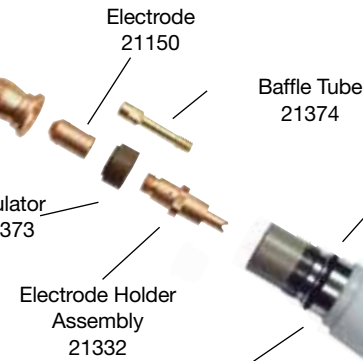

| Torch Body | Part Number |
|------------|-------------|
| PT-20      | 21359       |
| PT-21      | 0558003611  |

### Spare Parts Kit

| Description               | Part Number | 21370<br>50 A | 21369<br>70 / 80 A | 0558004271<br>90 A | 21376<br>100 A |
|---------------------------|-------------|---------------|--------------------|--------------------|----------------|
| Electrode                 | 21150       | 5             | 5                  | 1                  | 5              |
| Electrode Insulator       | 21373       | 1             | 1                  | 1                  | 1              |
| Electrode Holder Assembly | 21332       | 1             | 1                  | 1                  | 1              |
| Nozzle 50 A               | 21330       | 5             | 5                  | 5                  | 5              |
| Nozzle 70 A               | 21329       | -             | 5                  | 5                  | 5              |
| Nozzle 90 A               | 0558004269  | -             | -                  | 5                  | -              |
| Nozzle 100 A              | 21328       | -             | -                  | -                  | 5              |
| Heat Shield 50 A          | 21447       | 2             | 1                  | 1                  | 1              |
| Heat Shield 70 - 100 A    | 21326       | -             | 2                  | 2                  | 2              |
| Baffle Tube               | 21374       | 1             | 1                  | 1                  | 1              |
| Pilot Arc Adaptor         | 19497       | 1             | 1                  | 5                  | 1              |
| Lubricant .25 oz          | 0558000443  | 1             | 1                  | 1                  | 1              |
| O-Ring                    | 488157      | 5             | 5                  | 1                  | 5              |
| Wrench, Seat/Baffle       | 21375       | 1             | 1                  | 1                  | 1              |
| Wrench, 1/16 in. Hex-Key  | 93750006    | 1             | 1                  | 1                  | 1              |
| Tool Box                  | 950272      | 1             | 1                  | 1                  | 1              |