

PT-121 / PT-121M

Plasmarc manual cutting torches



- Excellent performance—cuts up to 2 in. (50.8 mm); pierces up to ½ in. (12.7 mm)
- Automatic pilot arc starting
- Uses nitrogen or H-35 for plasma gas; uses air, nitrogen, oxygen, carbon dioxide or argon for cooling gas
- Choice of 75°, 90° or mechanical torches
- Extended front end available
- Gouging nozzles and heat shield available



Console

The PT-121 can be used with the following console:

- PCM-150

This highly versatile torch operates with a variety of gases and offers superior cutting and gouging capability.

Specifications

	PT-121
Cuts	2 in. (50.8 mm)
Current Capacity	150 A @ 100% Duty Cycle
Plasma Cutting	
Gas Requirements	N ₂ @ 25 psig (25 cfh) H-35 @ 65 psig (75 cfh)
Cooling Gas Requirements	N ₂ , Air @ 50 psig (345 cfh) CO ₂ @ 50 psig (270 cfh)
Plasma Gouging	
Gas Requirements	H-35 @ 20 psig (130 cfh)
Cooling Gas Requirements	*Ar, N ₂ , Air @ 50 psig (260 cfh)
Length of Service Leads	25 ft. (7.6 m) 50 ft. (15.2 m)

*Argon preferred

Ordering Information

PT-121, 75°	
25 ft. (7.6 m) lead	999242
50 ft. (15.2) lead	999243
PT-121, 90°	
25 ft. (7.6 m) lead	999246
50 ft. (15.2 m) lead	999247
PT-121, Mechanical	
25 ft. (7.6 m) lead	999244
50 ft. (15.2 m) lead	999245

Optional Accessories

150 A Spare Parts Kit	19539
Plasma Flow Measuring Kit	0558000739
Plasmit Torch Protector	
75°	20742
90°	20801
Mechanical.....	20802
Leather Sheath, 10 ft. (254 cm)	20812
Gouging Heat Shield	
Heavy Duty.....	20087
Two-Piece Non-Ceramic	20378
1.6 mm Cutting Nozzle	20859
Use with centering adjustment tool (P/N 948178)	



PT-121 / PT-121M

Plasmarc manual cutting torch

Cutting Nozzle	Part Number	Orifice Size
30 A	17184	.032
55 A	17119	.047
110 A	999263	.055
150 A	999264	.063
Gouging Nozzle	Part Number	
70 A	20386	
100 A	20387	
150 A	19160	

Torch Body	Part Number
90°	999283
75°	999248
Mechanized	999270

Shield	Part Number
Standard	999261
50 A, Drag	999620
120 A, Drag	18419

Shield	Part Number
Long	18363
Gouging	31411

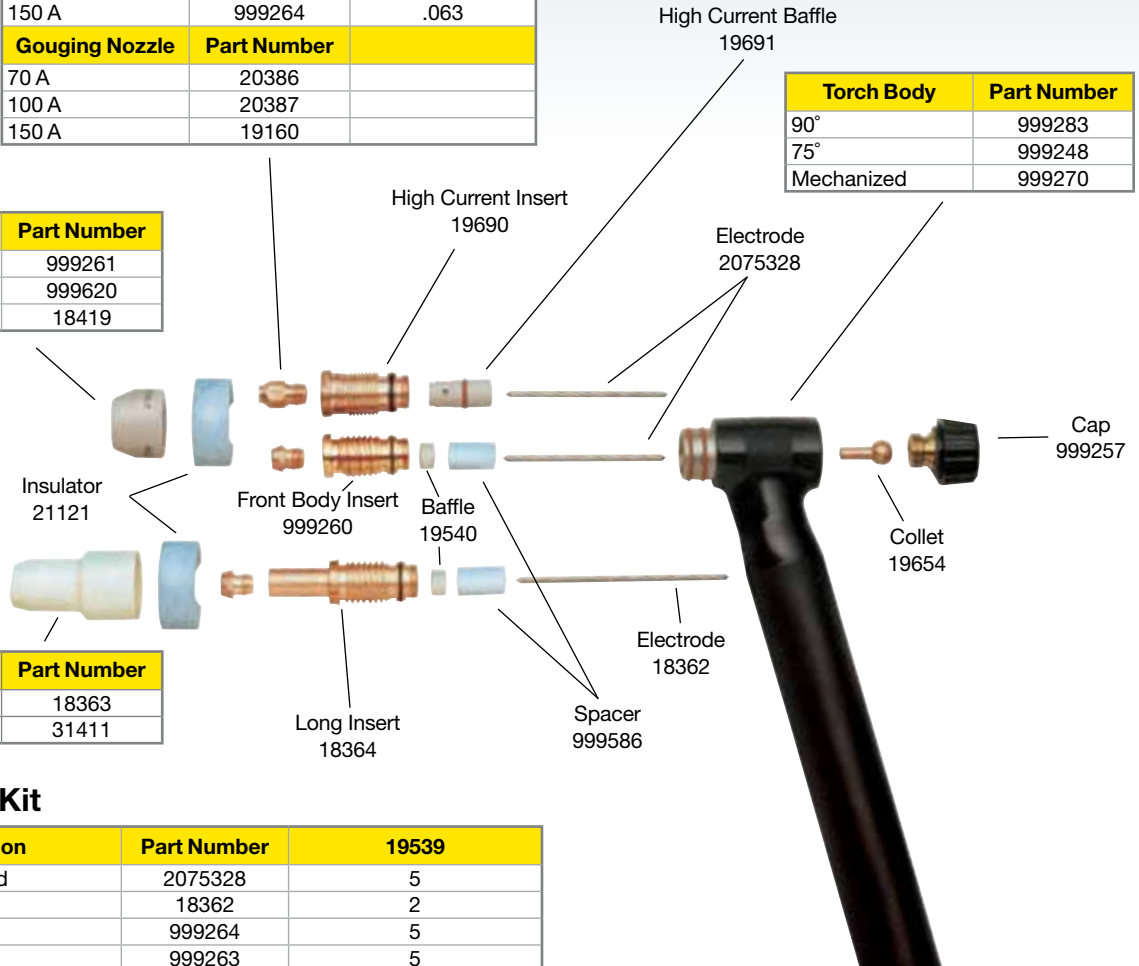

Spare Parts Kit

Description	Part Number	19539
Electrode, Standard	2075328	5
Electrode, Long	18362	2
Nozzle 150 A	999264	5
Nozzle 110 A	999263	5
Nozzle 55 A	17119	5
Nozzle Gouging 150 A	19160	2
Collet (Copper), Heavy Duty	19654	2
Heat Shield	999261	2
Heat Shield, Long	18363	2
Heat Shield, Gouging	31411	2
Heat Shield, Drag	18419	2
Front Body Insert	999260	1
Front Body Insert, Long	18364	1
High Current Insert	19690	2
High Current Baffle	19691	2
Baffle	19540	2
Spacer	999586	1
Torch Cap	999257	1
Lubricant .25 oz	0558000443	1
O-Ring	994092	5
O-Ring	96W97	2
O-Ring	85W50	2
Wrench	999568	1
Center-Adjust Tool	999266	2
Tool Box	950272	1

Torches

